

GA - GROUNDING CLAMP

GA-38

Description

Purpose: Connection between ground rod and cable or rebar-cable. Suitable for CS - COPPERSTEEL or copper cables.

Characteristics: Tightening connection. High electrical conductivity and corrosion resistant. Allows connecting conductors in parallel.

Application: Grounding systems in general.

Material: Copper alloy body. Clamp: electrolytic zinc plated steel (GA-12) or copper alloy (GA-38).

Finish: GA-38 tin plated

Application Tool: Spanner set or open-ended wrench.

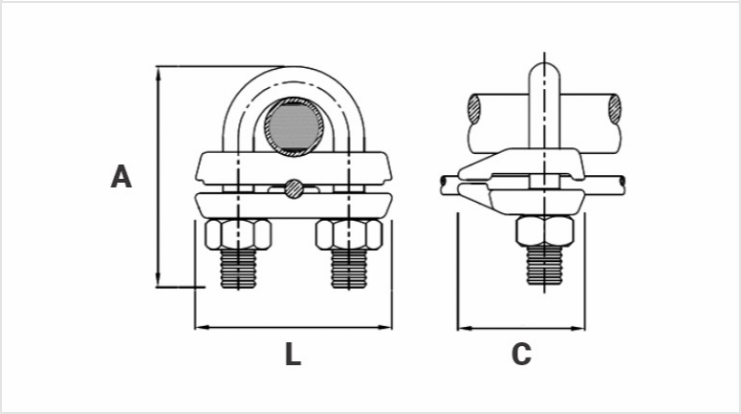

Datasheet

"U" Clamp Material		Liga de Cobre
Ground Rod Nominal Diameter (inches)		3/8"
Steel Rebar Diameter (Inches)		5/16" - 3/8"
Conductor		
AWG/MCM		8 - 1/0
mm²		10 - 50
Dimensions (mm)		
L		33,0
A		51,00
C		26,0
Package		
Qty. / Package		60
Unit Weight (g)		88,00