

GTDU - U-BOLT GROUNDING CLAMP (1 CONDUCTOR)

GTDU-3/8"-IPS-2/0-250

Description

Purpose: Connection between ground rod to cable or IPS tube-cable. Suitable for COPPERSTEEL or copper cables.

Characteristics: Tightening connection. High electrical conductivity and corrosion resistant. It allows you to connect a cable, at 90º in relation to the rod / IPS tube.

Application: Grounding systems in general (power distribution systems, grounding grids, residential, building and industrial grounding, grounding in telecommunication networks, grounding in substations).

Material: Copper alloy clamp, fittings in copper alloy or electrolytic zinc plated steel.

Application Tool: Spanner set or open-ended wrench.

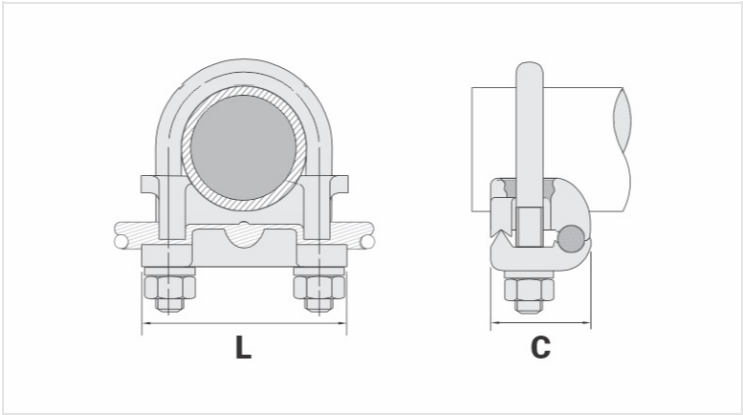

Datasheet

Conductor

AWG/MCM	2/0 - 250
mm²	70 - 120

Ground Rod Nominal Diameter (inches)	5/8" - 3/4"
--------------------------------------	-------------

IPS Tube	3/8"
----------	------

Accessory Material	Aço Zincado
--------------------	-------------

Dimensions (mm)

L	54,0
A	65,0
C	48,0
Screw "U"	M10
Figure	1

Package

Qty. / Package	15
Unit Weight (g)	395,00