

GTDU - U-BOLT GROUNDING CLAMP (1 CONDUCTOR)

GTDU-3/8"-IPS-8-4

Description

- Purpose:** Connection between ground rod to cable or IPS tube-cable. Suitable for COPPERSTEEL or copper cables.
- Characteristics:** Tightening connection. High electrical conductivity and corrosion resistant. It allows you to connect a cable, at 90º in relation to the rod / IPS tube.
- Application:** Grounding systems in general (power distribution systems, grounding grids, residential, building and industrial grounding, grounding in telecommunication networks, grounding in substations).
- Material:** Copper alloy clamp, fittings in copper alloy or electrolytic zinc plated steel.
- Application Tool:** Spanner set or open-ended wrench.

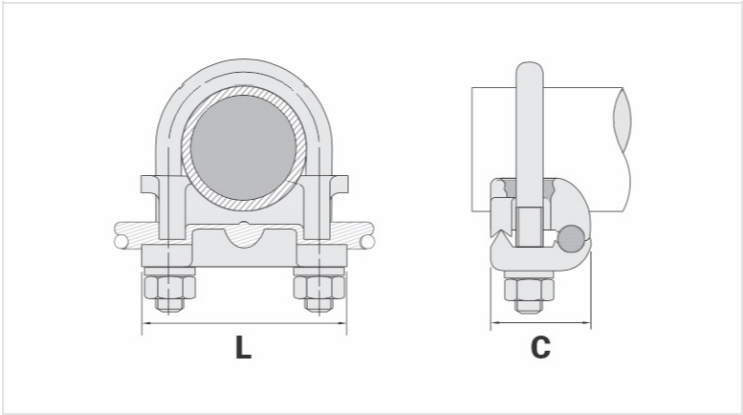

Datasheet

Conductor		
AWG/MCM		8 - 4
mm²		10 - 25
Ground Rod Nominal Diameter (inches)		5/8" - 3/4"
IPS Tube		3/8"
Accessory Material		Liga de Cobre
Dimensions (mm)		
L		50,0
A		65,0
C		34,0
Screw "U"		M10
Figure		1
Package		
Qty. / Package		25
Unit Weight (g)		212,00