

GTDU - U-BOLT GROUNDING CLAMP (1 CONDUCTOR)

GTDU-2.1/2"-IPS-2/0-250

Description

**Purpose:** Connection between ground rod to cable or IPS tube-cable. Suitable for COPPERSTEEL or copper cables.

**Characteristics:** Tightening connection. High electrical conductivity and corrosion resistant. It allows you to connect a cable, at 90º in relation to the rod / IPS tube.

**Application:** Grounding systems in general (power distribution systems, grounding grids, residential, building and industrial grounding, grounding in telecommunication networks, grounding in substations).

**Material:** Copper alloy clamp, fittings in copper alloy or electrolytic zinc plated steel.

**Application Tool:** Spanner set or open-ended wrench.

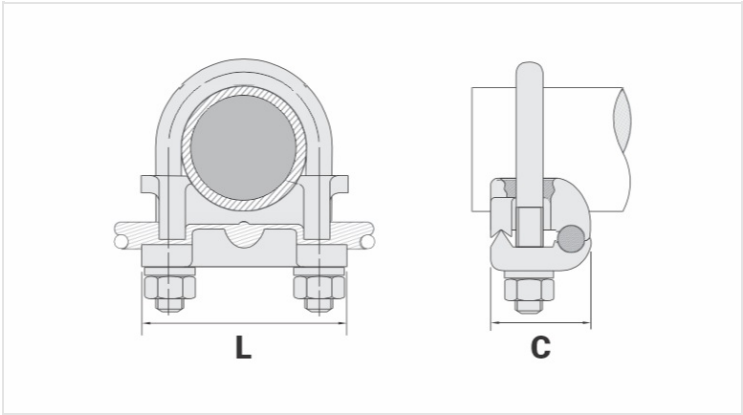
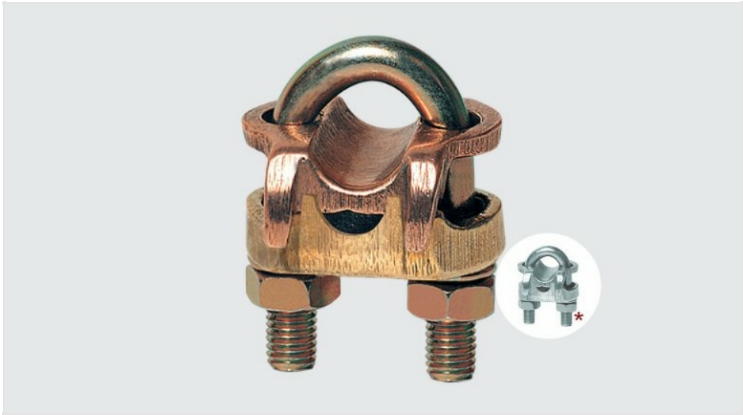

Datasheet

|                                      |  |               |
|--------------------------------------|--|---------------|
| Conductor                            |  |               |
| AWG/MCM                              |  | 2/0 - 250     |
| mm²                                  |  | 70 - 120      |
| Ground Rod Nominal Diameter (inches) |  | -             |
| IPS Tube                             |  | 2.1/2"        |
| Accessory Material                   |  | Liga de Cobre |
| Dimensions (mm)                      |  |               |
| L                                    |  | 111,0         |
| A                                    |  | 135,0         |
| C                                    |  | 48,0          |
| Screw "U"                            |  | M10           |
| Figure                               |  | 1             |
| Package                              |  |               |
| Qty. / Package                       |  | 10            |
| Unit Weight (g)                      |  | 795,80        |