

CCA - WEDGE TYPE CONNECTOR FOR GROUNDING

CCA-58-25

Description

**Purpose:** Connection between ground rod to cable. Suitable for COPPERSTEEL or copper cables.

**Characteristics:** Spring system connection (permanent tightening). High resistance to corrosion. Easy application. Supplied with antioxidant compound INTELTRON-Cu.

**Application:** Grounding systems in general (power distribution systems, grounding grids, residential, building and industrial grounding), grounding in telecommunication networks).

**Material:** Copper Alloy.

**Finish:** Tin plated Application Tool: Water pump pliers.

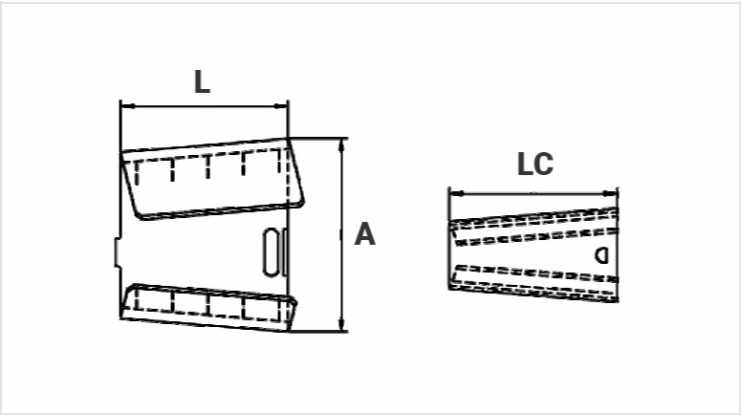

Datasheet

Conductor		
AWG/MCM		10 - 4
mm²		6 - 25
Ground Rod Diameter		5/8" (14,3mm)
Dimensions (mm)		
L		31,7
A		39,5
LC		31,7
Package		
Qty. / Package		50
Unit Weight (g)		58,00