

TTBC - COPPER CABLE-BUSBAR TERMINAL (STRAIGHT CONNECTION)

TTBC-2/0-4/0-2N

Description

- Purpose:** Cable to busbar termination for copper cables.
- Characteristics:** Tightening connection. High electrical conductivity. Pad with two or four holes NEMA standard. There are lugs that lock the head of the screws.
- Application:** Power distribution lines and substations.
- Material:** Bronze terminal, fittings in copper alloy.
- Application Tool:** Star or open-ended wrench.
- Note:** The use of the antioxidant compound INTELTROX-Cu is recommended.

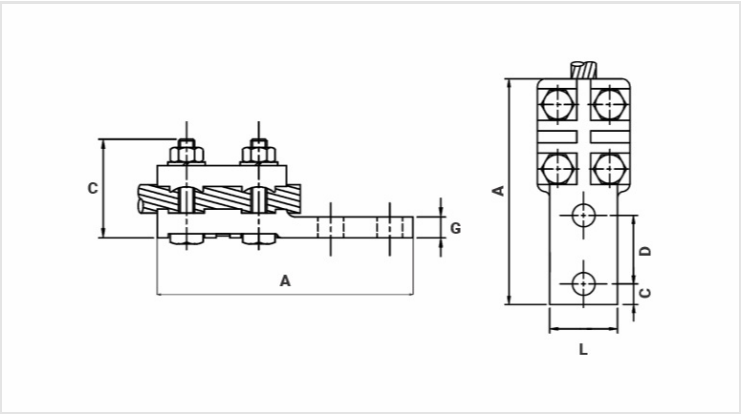

Datasheet

Conductors

Minimum	
mm²	70
AWG/MCM	2/0
Maximum	
mm²	120
AWG/MCM	4/0

Dimensions (mm)

Screw	M10
L	32,0
A	147,0
C	55,0
D	44,5
E	16,0
G	10,0
Qty. of Holes	2

Package

Qty. / Package	10
Unit Weight (g)	753,00

