

TTBC - COPPER CABLE-BUSBAR TERMINAL (STRAIGHT CONNECTION)

TTBC-500-800-4N

Description

- Purpose:** Cable to busbar termination for copper cables.
- Characteristics:** Tightening connection. High electrical conductivity. Pad with two or four holes NEMA standard. There are lugs that lock the head of the screws.
- Application:** Power distribution lines and substations.
- Material:** Bronze terminal, fittings in copper alloy.
- Application Tool:** Star or open-ended wrench.
- Note:** The use of the antioxidant compound INTELTROX-Cu is recommended.

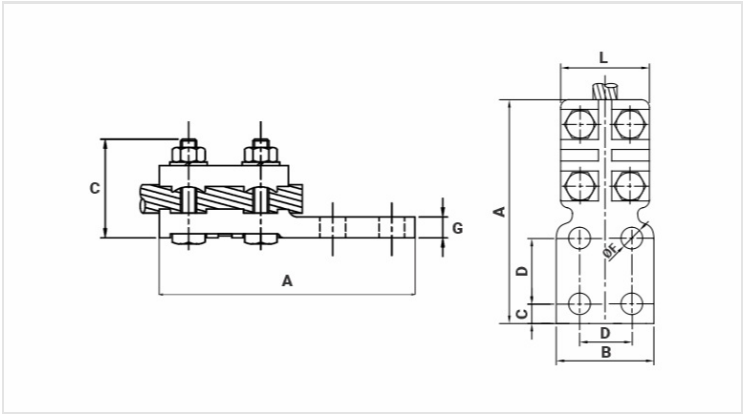

Datasheet

Conductors

Minimum	
mm ²	240
AWG/MCM	500
Maximum	
mm ²	400
AWG/MCM	800

Dimensions (mm)

Screw	M10
L	76,0
A	153,0
C	60,0
D	44,5
E	16,0
G	14,0
Qty. of Holes	4

Package

Qty. / Package	6
Unit Weight (g)	1558,00

