

TA - TIGHTENING TERMINAL (SYMMETRIC SERIES)

TA-6

Description

Purpose: Cable-busbar termination for copper cable (classes - 1/2/3). Connection to busbars, switchboards, electrical panels and others.

Characteristics: Mechanical pressure connection. Pad with one hole.

Application: Electrical installations in general (residential, building, industrial).

Material: Copper alloy terminal, electrolytic zinc plated steel nut.

Application Tool: Star or open-ended wrench.

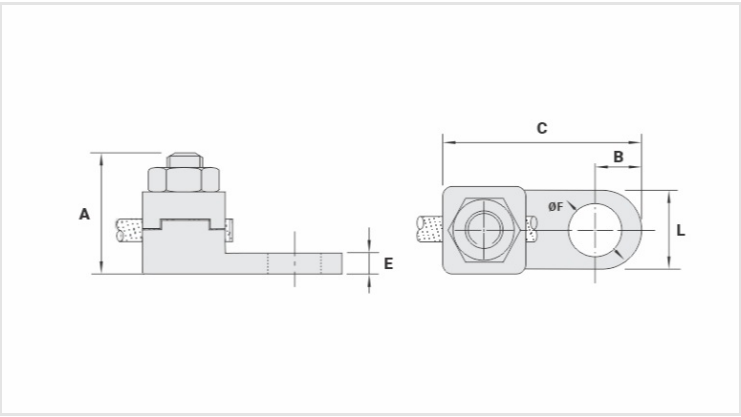

Datasheet

Conductor		
mm²		6
AWG/MCM		10
Screw		
Inches		3/16
Metric		M5
Dimensions (mm)		
L		11,0
A		21,0
C		28,0
B		5,5
E		3,0
ØF		5,4
Package		
Qty. / Package		100
Unit Weight (g)		20,30