

TA - TIGHTENING TERMINAL (SYMMETRIC SERIES)

TA-16

Description

**Purpose:** Cable-busbar termination for copper cable (classes - 1/2/3). Connection to busbars, switchboards, electrical panels and others.

**Characteristics:** Mechanical pressure connection. Pad with one hole.

**Application:** Electrical installations in general (residential, building, industrial).

**Material:** Copper alloy terminal, electrolytic zinc plated steel nut.

**Application Tool:** Star or open-ended wrench.

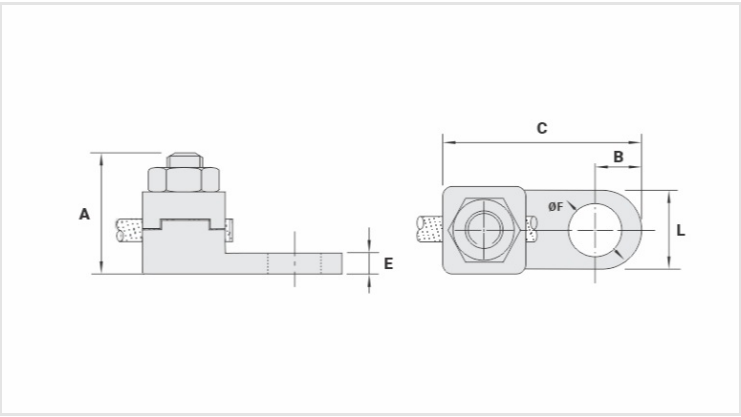

Datasheet

Conductor		
mm²		16
AWG/MCM		6
Screw		
Inches		1/4
Metric		M6
Dimensions (mm)		
L		11,0
A		21,0
C		28,0
B		6,5
E		3,5
ØF		6,5
Package		
Qty. / Package		100
Unit Weight (g)		24,00