

TA - TIGHTENING TERMINAL (SYMMETRIC SERIES)

TA-35

Description

Purpose: Cable-busbar termination for copper cable (classes - 1/2/3). Connection to busbars, switchboards, electrical panels and others.

Characteristics: Mechanical pressure connection. Pad with one hole.

Application: Electrical installations in general (residential, building, industrial).

Material: Copper alloy terminal, electrolytic zinc plated steel nut.

Application Tool: Star or open-ended wrench.

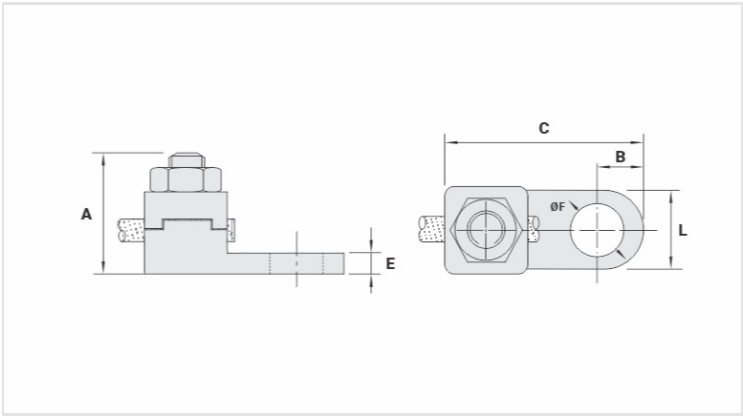

Datasheet

Conductor		
mm²		35
AWG/MCM		2
Screw		
Inches		1/4
Metric		M6
Dimensions (mm)		
L		13,5
A		24,0
C		32,0
B		7,0
E		4,0
ØF		6,5
Package		
Qty. / Package		50
Unit Weight (g)		32,80