

TA - TIGHTENING TERMINAL (SYMMETRIC SERIES)

TA-50

Description

**Purpose:** Cable-busbar termination for copper cable (classes - 1/2/3). Connection to busbars, switchboards, electrical panels and others.

**Characteristics:** Mechanical pressure connection. Pad with one hole.

**Application:** Electrical installations in general (residential, building, industrial).

**Material:** Copper alloy terminal, electrolytic zinc plated steel nut.

**Application Tool:** Star or open-ended wrench.

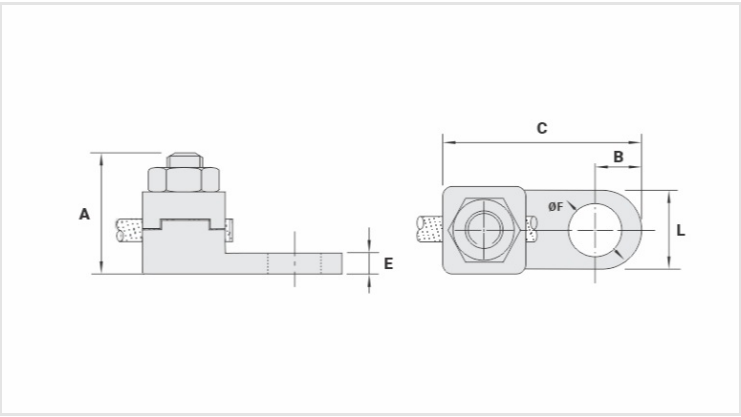

Datasheet

Conductor		
mm²		50
AWG/MCM		1/0
Screw		
Inches		5/16
Metric		M8
Dimensions (mm)		
L		16,0
A		29,0
C		41,0
B		8,5
E		4,0
ØF		8,5
Package		
Qty. / Package		30
Unit Weight (g)		58,80