

TA - TIGHTENING TERMINAL (SYMMETRIC SERIES)

TA-95

Description

**Purpose:** Cable-busbar termination for copper cable (classes - 1/2/3). Connection to busbars, switchboards, electrical panels and others.

**Characteristics:** Mechanical pressure connection. Pad with one hole.

**Application:** Electrical installations in general (residential, building, industrial).

**Material:** Copper alloy terminal, electrolytic zinc plated steel nut.

**Application Tool:** Star or open-ended wrench.

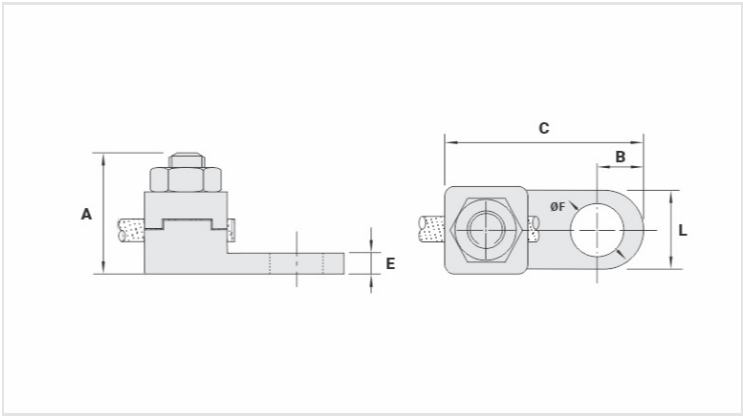

Datasheet

Conductor		
mm²		95
AWG/MCM		3/0
Screw		
Inches		3/8
Metric		M10
Dimensions (mm)		
L		21,0
A		34,0
C		50,5
B		10,5
E		5,0
ØF		10,5
Package		
Qty. / Package		30
Unit Weight (g)		104,00