

TA - TIGHTENING TERMINAL (SYMMETRIC SERIES)

TA-150

Description

**Purpose:** Cable-busbar termination for copper cable (classes - 1/2/3). Connection to busbars, switchboards, electrical panels and others.

**Characteristics:** Mechanical pressure connection. Pad with one hole.

**Application:** Electrical installations in general (residential, building, industrial).

**Material:** Copper alloy terminal, electrolytic zinc plated steel nut.

**Application Tool:** Star or open-ended wrench.

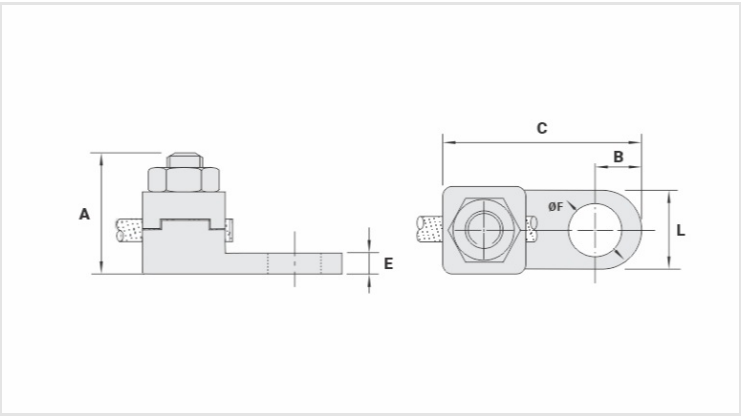

Datasheet

Conductor		
mm²		150
AWG/MCM		250
Screw		
Inches		1/2
Metric		M12
Dimensions (mm)		
L		24,5
A		41,0
C		59,5
B		12,5
E		5,0
ØF		13,5
Package		
Qty. / Package		20
Unit Weight (g)		154,60