

TA - TIGHTENING TERMINAL (SYMMETRIC SERIES)

TA-185

Description

Purpose: Cable-busbar termination for copper cable (classes - 1/2/3). Connection to busbars, switchboards, electrical panels and others.

Characteristics: Mechanical pressure connection. Pad with one hole.

Application: Electrical installations in general (residential, building, industrial).

Material: Copper alloy terminal, electrolytic zinc plated steel nut.

Application Tool: Star or open-ended wrench.

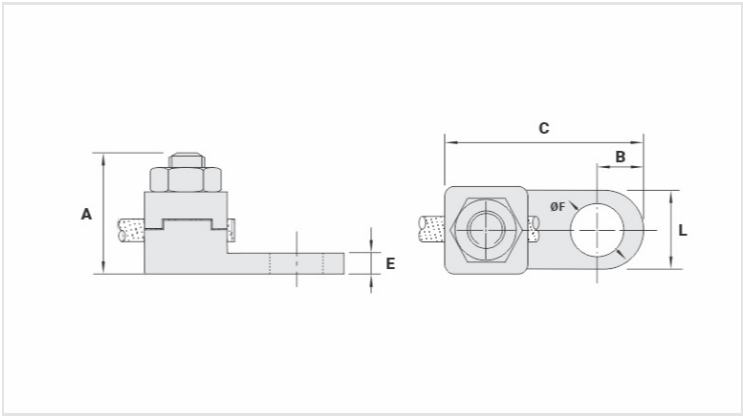

Datasheet

Conductor		
mm²		185
AWG/MCM		300
Screw		
Pol.		1/2
Métrico		M12
Dimensions		
L		26,0
A		41,0
C		65,0
B		13,5
E		6,0
ØF		13,5
Package		
Qtd / Emb		15
Peso Unit. (g)		195,20