

TA - TIGHTENING TERMINAL (SYMMETRIC SERIES)

TA-300

Description

Purpose: Cable-busbar termination for copper cable (classes - 1/2/3). Connection to busbars, switchboards, electrical panels and others.

Characteristics: Mechanical pressure connection. Pad with one hole.

Application: Electrical installations in general (residential, building, industrial).

Material: Copper alloy terminal, electrolytic zinc plated steel nut.

Application Tool: Star or open-ended wrench.

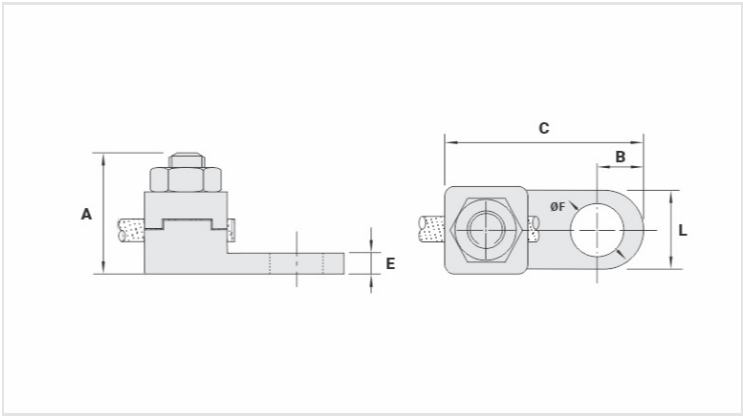

Datasheet

Conductor		
mm²		300
AWG/MCM		600
Screw		
Inches		9/16
Metric		M14
Dimensions (mm)		
L		30,0
A		50,0
C		69,0
B		15,0
E		6,5
ØF		15,5
Package		
Qty. / Package		10
Unit Weight (g)		228,60