

LF - SPLICE SLEEVE FOR COPPER CABLES (LOW TRACTION)

LF-35

Description

- Purpose:** Rigid or flexible copper cable splice (low traction).
- Characteristics:** Compression connection. High electrical conductivity and corrosion resistance. Expanded shape ends for easy insertion of flexible conductors. With center wire stop.
- Application:** Electrical installations in general (residential, building, industrial).
- Material:** Electrolytic copper.
- Finish:** Tin plated.

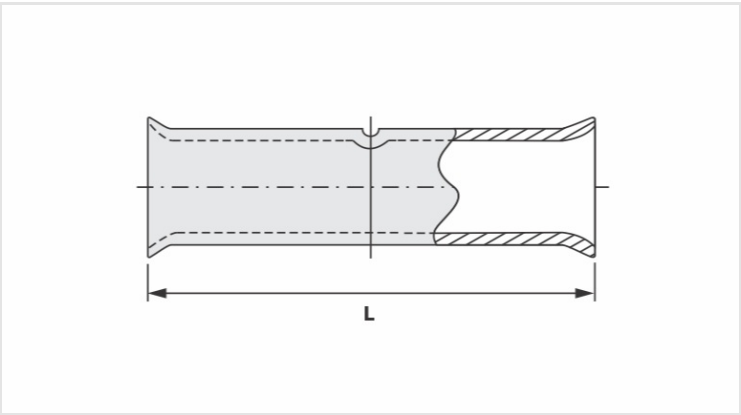

Datasheet

|                                  |          |
|----------------------------------|----------|
| Conductors - Cross Section (mm²) | 35       |
| Current (A)                      | 226      |
| Dimension (mm) - L               | 42,0     |
| Application Tool                 |          |
| Mechanical Pliers                |          |
| Model                            | AT-60/68 |
| Die (AT-60)                      | IW-4     |
| Hydraulic Pliers (AY/CY/AHM/AHB) |          |
| Circunferencial Die              | IU-4     |
| Hexagonal Die                    | H-4      |
| Package                          |          |
| Qty. / Package                   | 50       |
| Unit Weight (g)                  | 13,20    |