

LF - SPLICE SLEEVE FOR COPPER CABLES (LOW TRACTION)

LF-240

Description

- Purpose:** Rigid or flexible copper cable splice (low traction).
- Characteristics:** Compression connection. High electrical conductivity and corrosion resistance. Expanded shape ends for easy insertion of flexible conductors. With center wire stop.
- Application:** Electrical installations in general (residential, building, industrial).
- Material:** Electrolytic copper.
- Finish:** Tin plated.

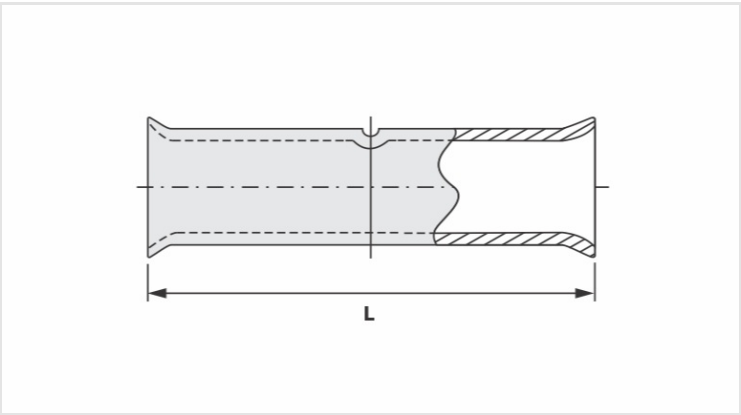

Datasheet

Conductors - Cross Section (mm²)	240
Current (A)	781
Dimension (mm) - L	71,0
Application Tool	
Mechanical Pliers	
Model	-
Die (AT-60)	-
Hydraulic Pliers (AY/CY/AHM/AHB)	
Circunferencial Die	IU-34**
Hexagonal Die	H-34
Package	
Qty. / Package	15
Unit Weight (g)	113