

TPT - TUBULAR RING TYPE PRE-INSULATED TERMINALS

TPT-10-8

Description

Purpose: Termination of rigid or flexible copper cables.

Characteristics: Compression connection. High electrical conductivity and corrosion resistance.

Application: Electrical installations in general (residential, building, industrial). Circuits up to 90°C and 750V.

Material: Electrolytic copper and polypropylene insulation.

Finish: Tin plated and insulated. Application Tool: ATP-49.

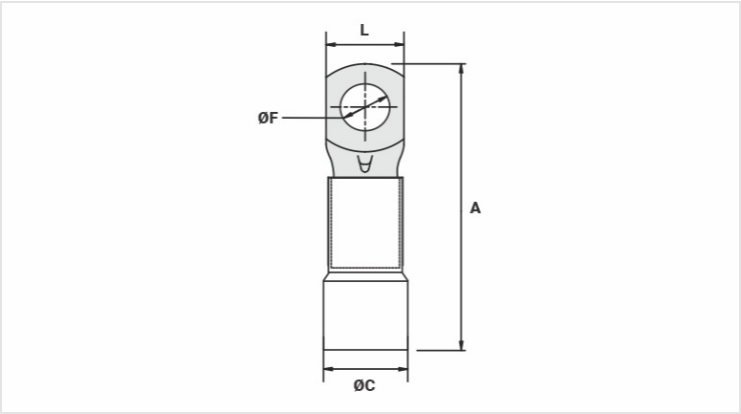

Datasheet

Insulation per DIN Standard (Color)	VERMELHO
Conductors - Cross Section (mm²)	10
Dimensions (mm)	
L	13,0
A	36,0
C	6,0
ØF	8,5
Maximum Current (A)	101
Package	
Qtd / Emb	100
Peso Unit. (g)	4,00