

TPT - TUBULAR RING TYPE PRE-INSULATED TERMINALS

TPT-35-10

Description

- Purpose:** Termination of rigid or flexible copper cables.
- Characteristics:** Compression connection. High electrical conductivity and corrosion resistance.
- Application:** Electrical installations in general (residential, building, industrial). Circuits up to 90°C and 750V.
- Material:** Electrolytic copper and polypropylene insulation.
- Finish:** Tin plated and insulated. Application Tool: ATP-49.

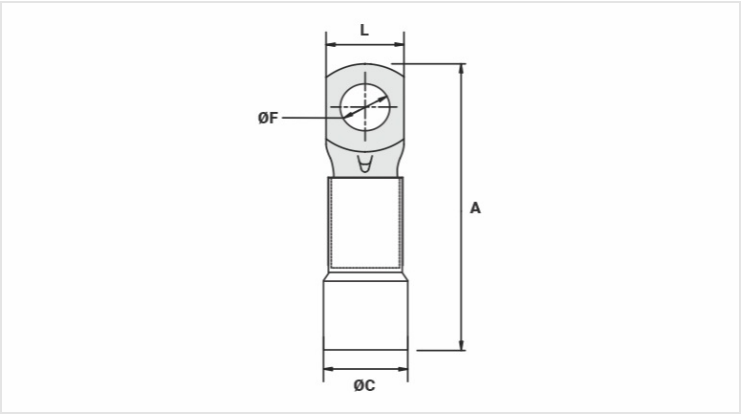

Datasheet

Insulation per DIN Standard (Color)	VERMELHO
Conductors - Cross Section (mm²)	35
Dimensions (mm)	
L	14,9
A	49,0
C	10,3
ØF	10,5
Maximum Current (A)	226
Package	
Qtd / Emb	100
Peso Unit. (g)	10,12