

TPT - TUBULAR RING TYPE PRE-INSULATED TERMINALS

TPT-70-13

Description

- Purpose:** Termination of rigid or flexible copper cables.
- Characteristics:** Compression connection. High electrical conductivity and corrosion resistance.
- Application:** Electrical installations in general (residential, building, industrial). Circuits up to 90°C and 750V.
- Material:** Electrolytic copper and polypropylene insulation.
- Finish:** Tin plated and insulated. Application Tool: ATP-49.

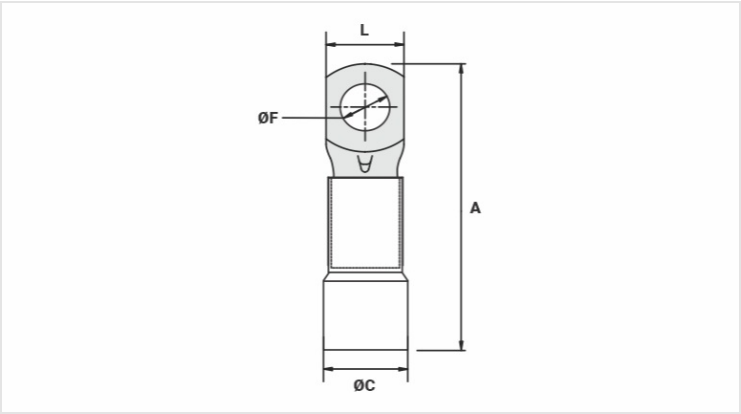

Datasheet

Insulation per DIN Standard (Color)	AMARELO
Conductors - Cross Section (mm ²)	70
Dimensions (mm)	
L	20,3
A	65,0
C	14,0
ØF	13,0
Maximum Current (A)	353
Package	
Qtd / Emb	50
Peso Unit. (g)	22,00