

LEP - PRE-INSULATED SPLICE SLEEVE

LEP-1,5

Description

- Purpose:** Splice (reduced traction) of rigid or flexible copper cable.
- Characteristics:** Compression connection. High electrical conductivity and corrosion resistance.
- Application:** Electrical installations in general (residential, building, industrial). Circuits up to 70°C and 750V.
- Material:** Electrolytic copper and insulation in rigid PVC.
- Finish:** Tin plated and insulated.
- Application Tool:** AT-10 or ATC-6.

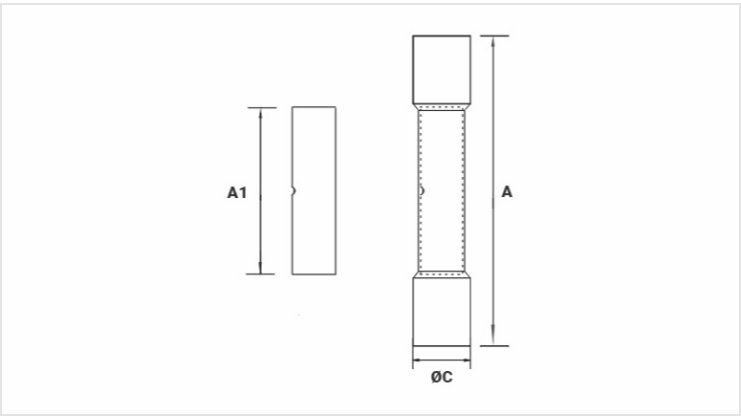

Datasheet

| | | |
|-------------------------------------|--|-----------------------|
| Insulation per DIN Standard (Color) | | VERMELHO / RED / ROJO |
| Conductor | | |
| AWG/MCM | | 22 - 16 |
| mm² | | 0,5 - 1,5 |
| Dimensions (mm) | | |
| L | | 5,1 |
| A | | 27,0 |
| A1 | | 15,0 |
| Maximum Current (A) | | 19 |
| Package | | |
| Qty. / Package | | 100 |
| Unit Weight (g) | | 0,85 |