

LEP - PRE-INSULATED SPLICE SLEEVE

LEP-2,5

Description

- Purpose:** Splice (reduced traction) of rigid or flexible copper cable.
- Characteristics:** Compression connection. High electrical conductivity and corrosion resistance.
- Application:** Electrical installations in general (residential, building, industrial). Circuits up to 70°C and 750V.
- Material:** Electrolytic copper and insulation in rigid PVC.
- Finish:** Tin plated and insulated.
- Application Tool:** AT-10 or ATC-6.

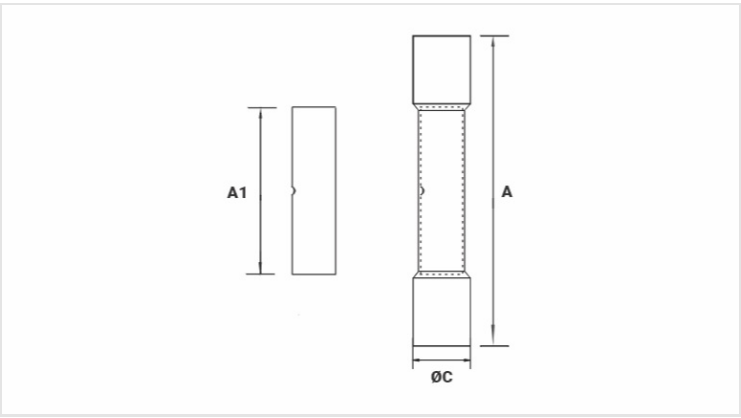

Datasheet

Insulation per DIN Standard (Color)		AZUL / BLUE
Conductor		
AWG/MCM		16 - 14
mm²		1,5 - 2,5
Dimensions (mm)		
L		5,5
A		27,0
A1		15,0
Maximum Current (A)		27
Package		
Qty. / Package		100
Unit Weight (g)		1,00