

TID - DOBLE EYELET TYPE PRE-INSULATED TERMINALS

TID-0,5-8

Description

Purpose: Termination of rigid or flexible copper cables for terminal blocks. Recommended for application of two conductors.

Characteristics: Compression connection. High electrical conductivity and corrosion resistance.

Application: Electrical installations in general (residential, building, industrial). Circuits up to 105°C and 750V.

Material: Electrolytic copper and nylon insulation.

Finish: Tin plated and insulated.

Application Tool: ATIC-6 (TID-0,5 to TID-4) or ATIC-35 (TID-6 to TID-16).

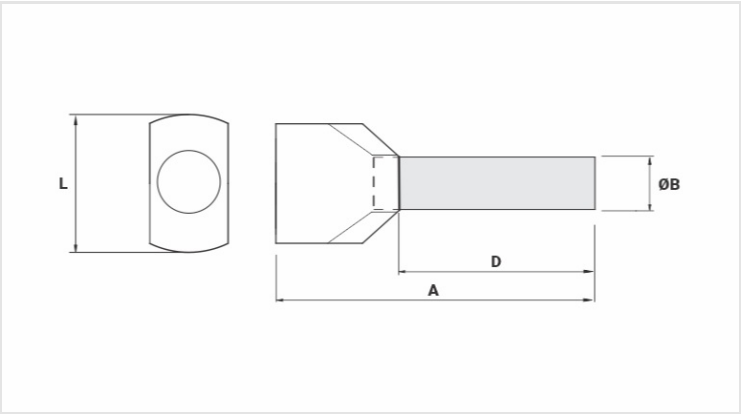
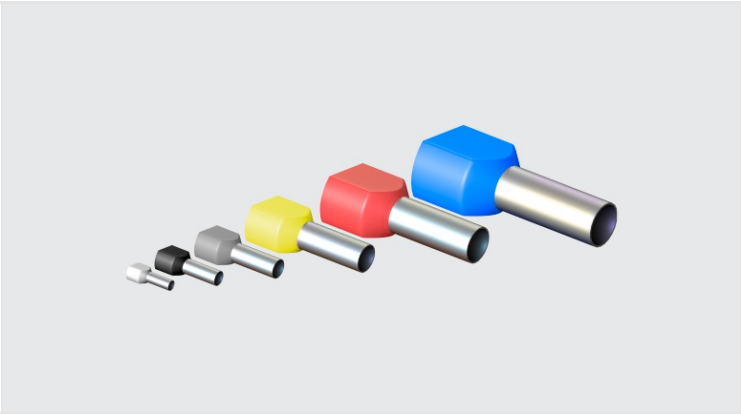

Datasheet

Insulation per DIN Standard (Color)		BRANCO
Conductor		
AWG/MCM		2x 22
mm²		2x 0,5
Dimensions (mm)		
L		5,7
A		14,5
C		
Ø B		1,8
D		8,0
Maximum Current (A)		9
Package		
Qtd / Emb		100
Peso Unit. (g)		0,12