

TID - DOBLE EYELET TYPE PRE-INSULATED TERMINALS

TID-0,75-8

Description

- Purpose:** Termination of rigid or flexible copper cables for terminal blocks. Recommended for application of two conductors.
- Characteristics:** Compression connection. High electrical conductivity and corrosion resistance.
- Application:** Electrical installations in general (residential, building, industrial). Circuits up to 105°C and 750V.
- Material:** Electrolytic copper and nylon insulation.
- Finish:** Tin plated and insulated.
- Application Tool:** ATIC-6 (TID-0,5 to TID-4) or ATIC-35 (TID-6 to TID-16).

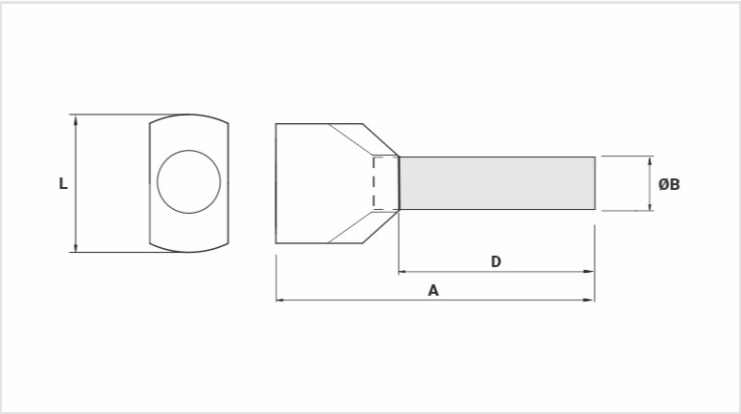
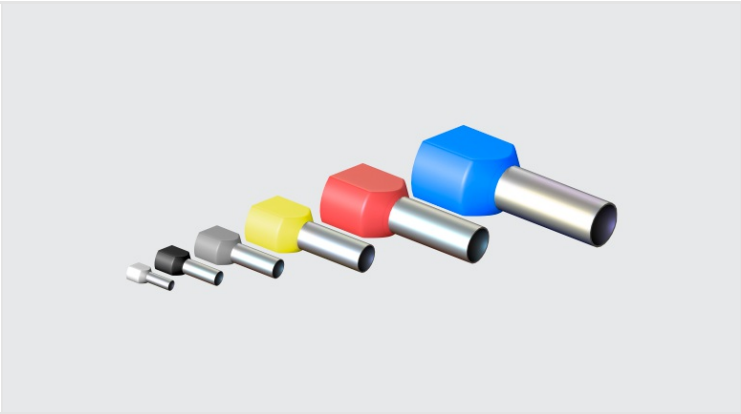

Datasheet

Insulation per DIN Standard (Color)		CINZA
Conductor		
AWG/MCM		2x 20
mm²		2x 0,75
Dimensions (mm)		
L		6,4
A		14,7
C		
Ø B		2,1
D		8,0
Maximum Current (A)		12
Package		
Qtd / Emb		100
Peso Unit. (g)		0,15