

TID - DOBLE EYELET TYPE PRE-INSULATED TERMINALS

TID-2,5-10

Description

- Purpose:** Termination of rigid or flexible copper cables for terminal blocks. Recommended for application of two conductors.
- Characteristics:** Compression connection. High electrical conductivity and corrosion resistance.
- Application:** Electrical installations in general (residential, building, industrial). Circuits up to 105°C and 750V.
- Material:** Electrolytic copper and nylon insulation.
- Finish:** Tin plated and insulated.
- Application Tool:** ATIC-6 (TID-0,5 to TID-4) or ATIC-35 (TID-6 to TID-16).

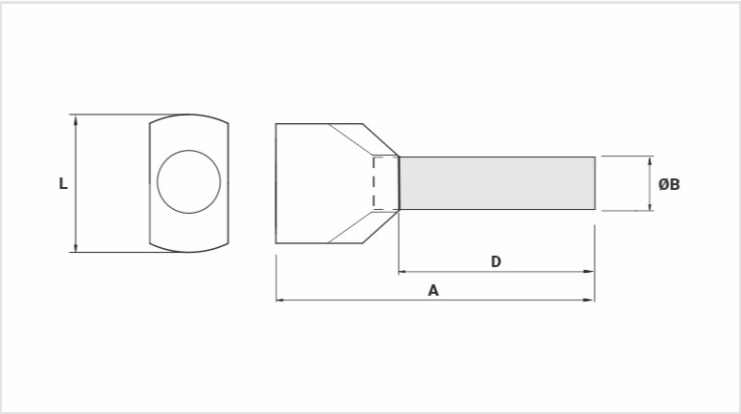
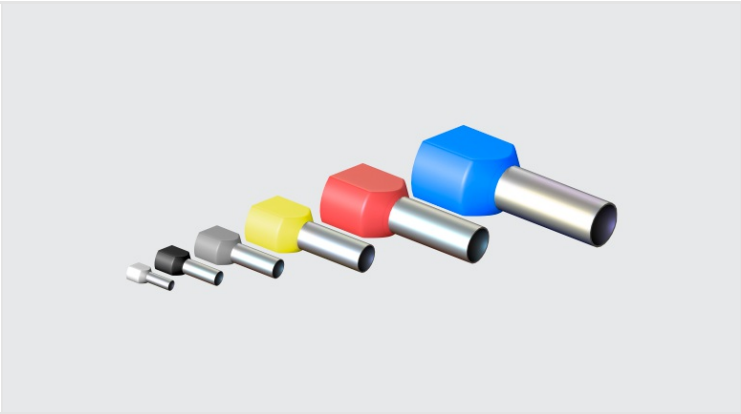

Datasheet

Insulation per DIN Standard (Color)		AZUL
Conductor		
AWG/MCM		2x 14
mm²		2x 2,5
Dimensions (mm)		
L		9,0
A		18,5
C		
Ø B		3,3
D		10,0
Maximum Current (A)		30
Package		
Qtd / Emb		100
Peso Unit. (g)		0,35