

GTDB - BUSBAR DOUBLE GROUNDING CLAMPS (1 CONDUCTOR)

GTDB-8-4

Description

Purpose: Cable to busbar connections. Suitable for COPPERSTEEL or copper cables.

Characteristics: Tightening connection. High electrical conductivity and corrosion resistant. Single conductor version. Enough screw length for plate/bar thickness up to 7mm.

Application: Grounding systems in general (power distribution systems, grounding grids, residential, building, industrial grounding, grounding in telecommunication networks).

Material: Bronze clamp, fittings in copper alloy or hot galvanized steel.

Application Tool: Spanner set or open-ended wrench.

*Also available tin plated.

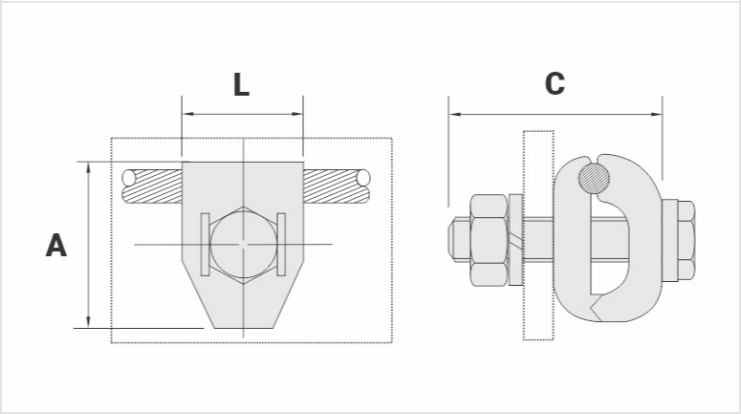
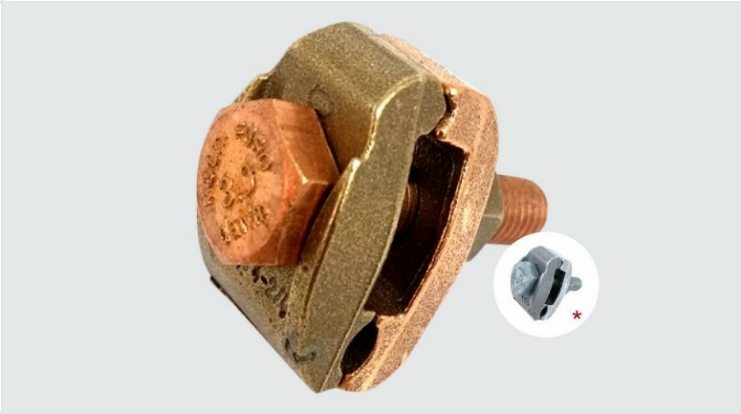

Datasheet

Conductor		
Cross Section (AWG/MCM)		8 - 4
mm²		10 - 25
Dimensions (mm)		
L		27,0
A		34,0
C		45,0
Screw - E		M10
Figure		1
Package		
Qty. / Package		30
Unit Weight (g)		135,50