

CODC - COPPER WEDGE TYPE CONNECTOR

CODC-56

Description

- Purpose:** COPPERSTEEL or copper connection, cable-cable and ground rod-cable.
- Characteristics:** Spring system connection (permanent tightening). High electrical conductivity and corrosion resistance.
- Application:** Power distribution lines, grounding systems in general.
- Material:** Bronze, Supplied with antioxidant compound INTELTROX-Cu.
- Application Tool:** Impact tool with cartridge for wedge connector.

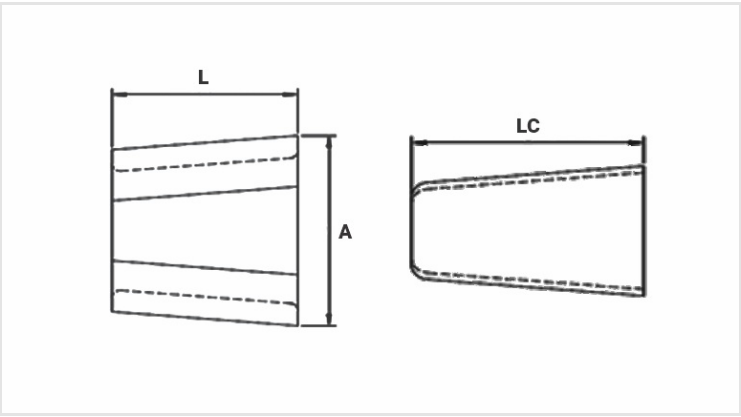

Datasheet

Application Cartridge Color		VERMELHO / RED / ROJO
Dimensions (mm)		
L		31,7
A		41,0
LC		38,5
Package		
Qty. / Package		20
Unit Weight (g)		147,00