

CODC - COPPER WEDGE TYPE CONNECTOR

CODC-120-6

Description

Purpose: COPPERSTEEL or copper connection, cable-cable and ground rod-cable.

Characteristics: Spring system connection (permanent tightening). High electrical conductivity and corrosion resistance.

Application: Power distribution lines, grounding systems in general.

Material: Bronze, Supplied with antioxide compound INTELTROX-Cu.

Application Tool: Impact tool with cartridge for wedge connector.

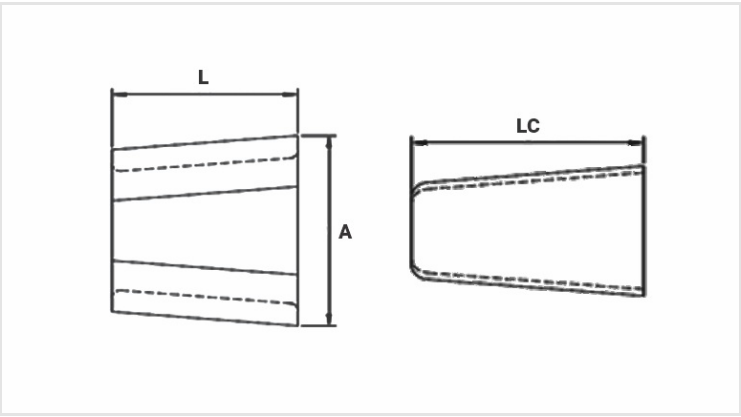

Datasheet

Application Cartridge Color		BRANCO / WHITE / BLANCO
Dimensions (mm)		
L		41,5
A		65,7
LC		50,0
Package		
Qty. / Package		20
Unit Weight (g)		401,00