

CODC - COPPER WEDGE TYPE CONNECTOR

CODC-120-8

Description

- Purpose:** COPPERSTEEL or copper connection, cable-cable and ground rod-cable.
- Characteristics:** Spring system connection (permanent tightening). High electrical conductivity and corrosion resistance.
- Application:** Power distribution lines, grounding systems in general.
- Material:** Bronze, Supplied with antioxide compound INTELTROX-Cu.
- Application Tool:** Impact tool with cartridge for wedge connector.

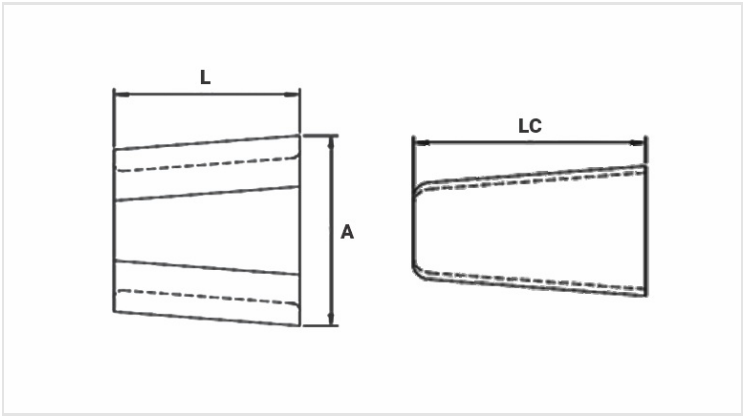

Datasheet

Application Cartridge Color		BRANCO / WHITE / BLANCO
Dimensions (mm)		
L		41,5
A		65,7
LC		50,0
Package		
Qty. / Package		20
Unit Weight (g)		381,20