

CAEL - ALUMINUM WEDGE TYPE CONNECTOR WITH STIRRUP (SIDE MODEL)

CAEL-20B

Description

- Purpose:** Connection with copper, aluminum CA and CAA cables. Allows ing of up to four wedge types or compression connectors.
- Characteristics:** Spring system connection (permanent tightening). High electrical conductivity and corrosion resistance.
- Application:** Power distribution lines.
- Material:** Aluminum alloy body and wedge and stirrup in electrolytic copper. Supplied with antioxide compound INTELTROX.
- Finishing (Stirrup):** Tin plated.
- Application Tool:** Impact tool with cartridge for wedge connector.

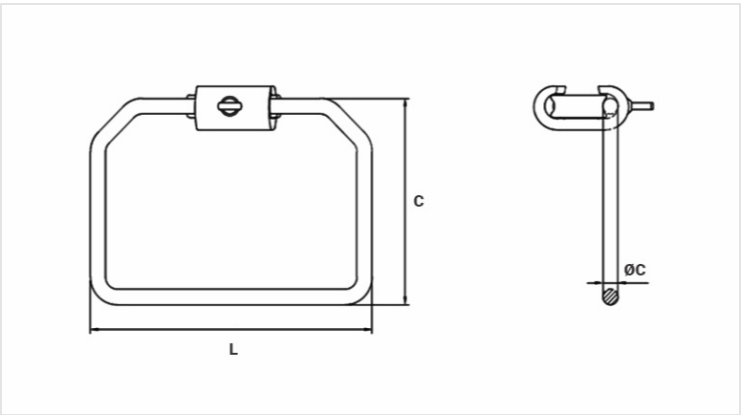

Datasheet

Application Cartridge Color		AZUL / BLUE
Conductors		
AWG/MCM		1/0 - 4/0
Type of Conductor		CA/CAA
Stirrup (AWG)		2
Dimensions (mm)		
L		121,0
C		88,0
Ø C		6,5
Package		
Qty. / Package		30
Unit Weight (g)		235,00