

CAEL - ALUMINUM WEDGE TYPE CONNECTOR WITH STIRRUP (SIDE MODEL)

CAEL-407

Description

- Purpose:** Connection with copper, aluminum CA and CAA cables. Allows ing of up to four wedge types or compression connectors.
- Characteristics:** Spring system connection (permanent tightening). High electrical conductivity and corrosion resistance.
- Application:** Power distribution lines.
- Material:** Aluminum alloy body and wedge and stirrup in electrolytic copper. Supplied with antioxide compound INTELTROX.
- Finishing (Stirrup):** Tin plated.
- Application Tool:** Impact tool with cartridge for wedge connector.

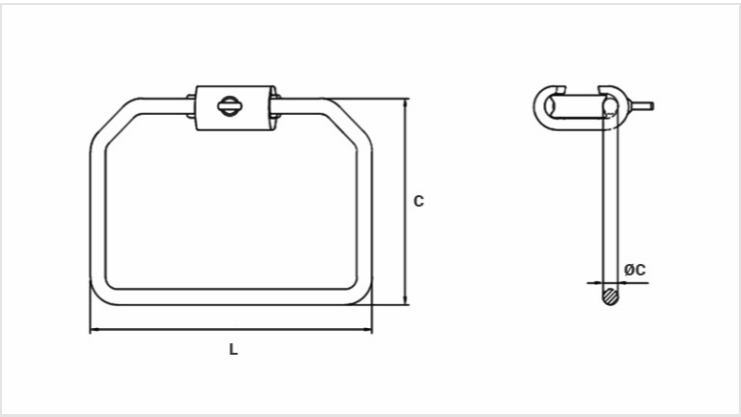

Datasheet

Application Cartridge Color		AMARELO / YELLOW / AMARILLO
Conductors		
AWG/MCM	336,4 - 397,5 (somente cabo 397,5 CA)	
Type of Conductor	CA/CAA	
Stirrup (AWG)		2
Dimensions (mm)		
L	121,0	
C	88,0	
Ø C	6,5	
Package		
Qty. / Package	20	
Unit Weight (g)	507,00	