

CAEP - ALUMINUM WEDGE TYPE CONNECTOR WITH STIRRUP (PROTECTED LINE MODEL)

CAEP-103

Description

**Purpose:** Connection with copper, aluminum CA and CAA cables. Enables ing of a hotline clamp in 15kV protected networks.

**Characteristics:** Spring system connection (permanent tightening). High electrical conductivity and corrosion resistance.

**Application:** Power distribution lines.

**Material:** Aluminum alloy body and wedge and stirrup in electrolytic copper. Supplied with antioxide compound INTELTROX.

**Finishing (Stirrup):** Tin plated.

**Application Tool:** Impact tool with cartridge for wedge connector.

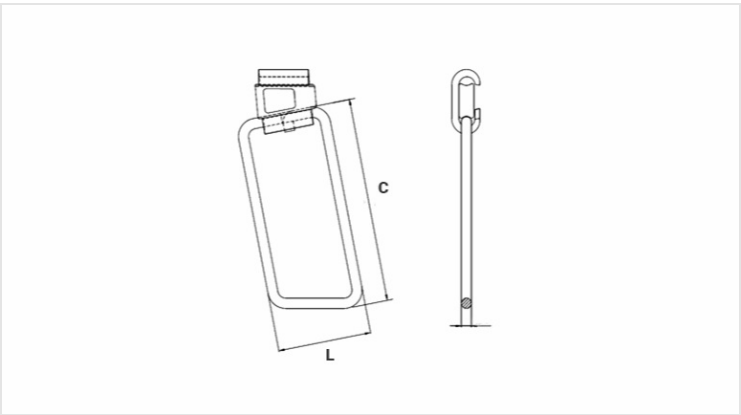

Datasheet

Application Cartridge Color		VERMELHO / RED / ROJO
Conductors		
AWG/MCM		4 - 2
Type of Conductor		CA/CAA
Stirrup (AWG)		2
Dimensions (mm)		
L		60,0
C		140,0
Ø C		6,5
Package		
Qty. / Package		30
Unit Weight (g)		151,40