

GTDB2C - BUSBAR DOUBLE GROUNDING CLAMPS (2 CONDUCTORS)

GTDB-2C-2/0-250

Description

- Purpose:** Cable to busbar connections. Suitable for COPPERSTEEL or copper cables.
- Characteristics:** Tightening connection. High electrical conductivity and corrosion resistant. Two conductors model. Enough screw length for plate/bar thickness up to 7mm.
- Application:** Grounding systems in general (power distribution systems, grounding grids, residential, building, industrial grounding, grounding in telecommunication networks).
- Material:** Bronze clamp, fittings in copper alloy or hot galvanized steel.
- Application Tool:** Spanner set or open-ended wrench.
- *Also available tin plated.

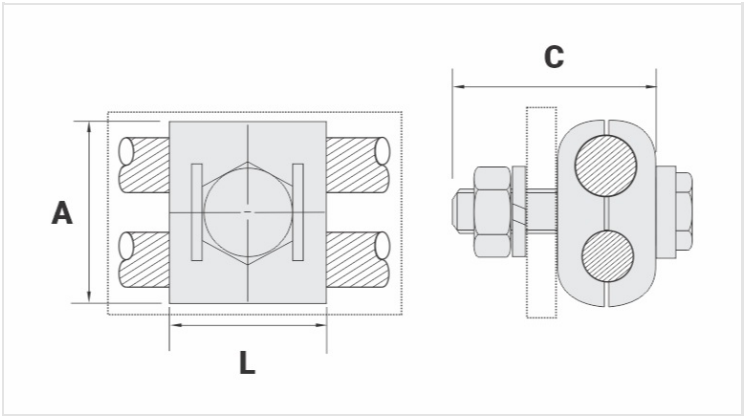
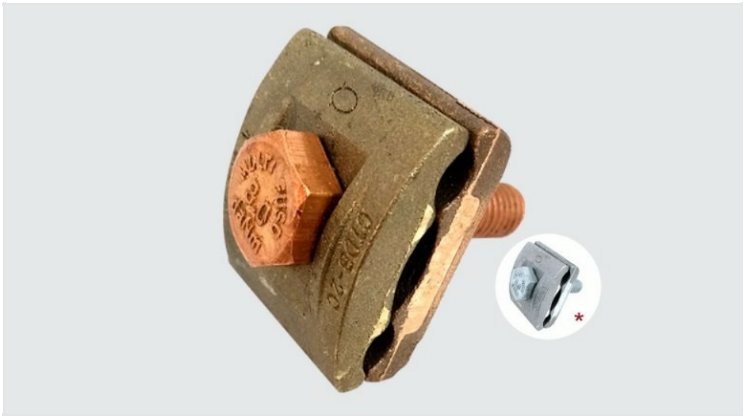

Datasheet

Conductor		
Cross Section (AWG/MCM)		2/0 - 250
mm²		70 - 120
Dimensions (mm)		
L		42,0
A		58,0
C		50,0
Screw - E		M12
Figure		2
Package		
Qty. / Package		15
Unit Weight (g)		433,00