

GTDB2C - BUSBAR DOUBLE GROUNDING CLAMPS (2 CONDUCTORS)

GTDB-2C-300-500

Description

Purpose: Cable to busbar connections. Suitable for COPPERSTEEL or copper cables.

Characteristics: Tightening connection. High electrical conductivity and corrosion resistant. Two conductors model. Enough screw length for plate/bar thickness up to 7mm.

Application: Grounding systems in general (power distribution systems, grounding grids, residential, building, industrial grounding, grounding in telecommunication networks).

Material: Bronze clamp, fittings in copper alloy or hot galvanized steel.

Application Tool: Spanner set or open-ended wrench.

*Also available tin plated.

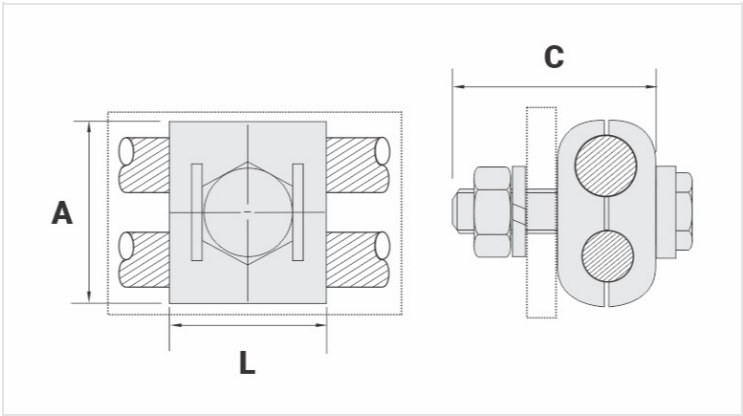
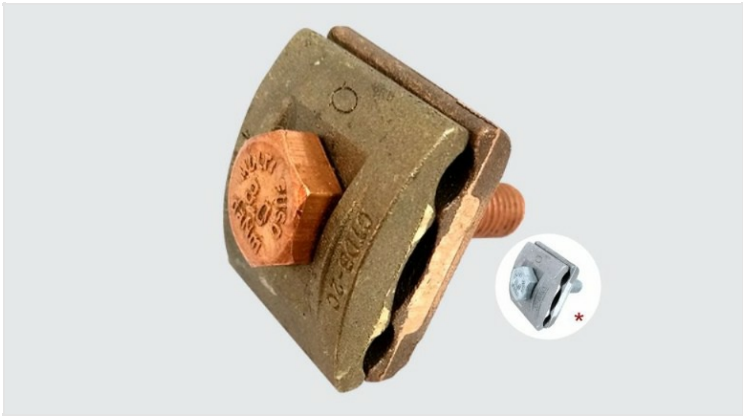

Datasheet

Conductor

Cross Section (AWG/MCM)	300 - 500
mm²	150 - 240

Dimensions (mm)

L	49,0
A	65,0
C	50,0
Screw - E	M12
Figure	2

Package

Qty. / Package	10
Unit Weight (g)	566,00