

CDPF - PIERCING CONNECTOR FOR FLEXIBLE CONDUCTORS

CDPF-120-240

Description

**Purpose:** Connection between input branch (Flexible copper cable Class-4/5 - PVC insulation 450 / 750v without cover) and connection branch (multiplexed CA aluminum conductors - XLPE / PE 0.6 / 1kV - phase and neutral (insulated or bare)).

**Characteristics:** Connection by piercing (no need to strip the insulation from the cable). It has a shear head nut to ensure a perfect connection. It has compensation springs that ensure a constant pression in the connection.

**Application:** Overhead insulated electricity distribution networks.

**Material:** Polymer connector resistant to weather and U.V rays. Tin plated copper contacts.

**Application Tool:** Star or socket wrench.

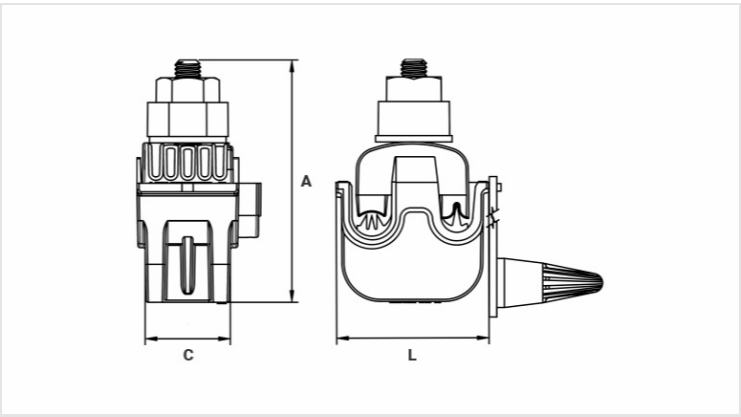

Datasheet

Conductors

Run - AAC/Cu - Class 2 (mm²)	50   70 - 120
Tap - Cu - Class 4/5 (mm²)	185   185 - 240

Dimensions (mm)

L	87,0
A	133,0
C	65,0

Package

Qty. / Package	8
Unit Weight (g)	540,00