

GTSB - GROUNDING CLAMP (1 CONDUCTOR)

GTSB-2/0-250

Description

- Purpose:** Cable to busbar connections. Suitable for copper or COPPERSTEEL cables.
- Characteristics:** Tightening connection. Electrical conductivity and corrosion resistant. Single conductor version. Screw length suitable for plate / bar thickness up to 7mm.
- Application:** Grounding systems in general (power distribution systems, grounding grids, residential, building, industrial grounding, grounding in telecommunications networks).
- Material:** Bronze clamp, fittings in copper alloy or hot galvanized steel.
- Application Tool:** Spanner set or open-ended wrench.
- \*Also available tin plated.

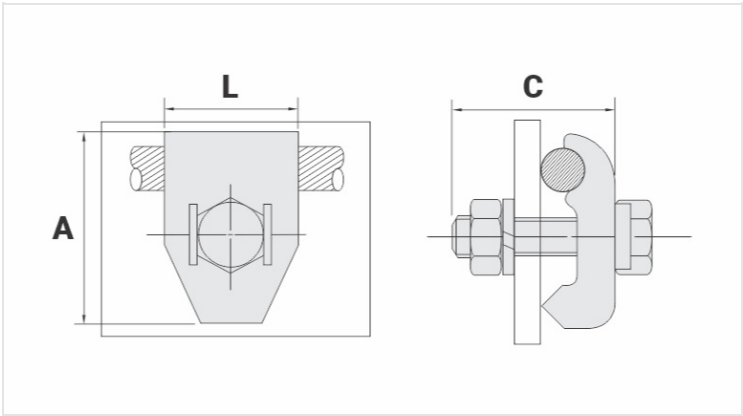
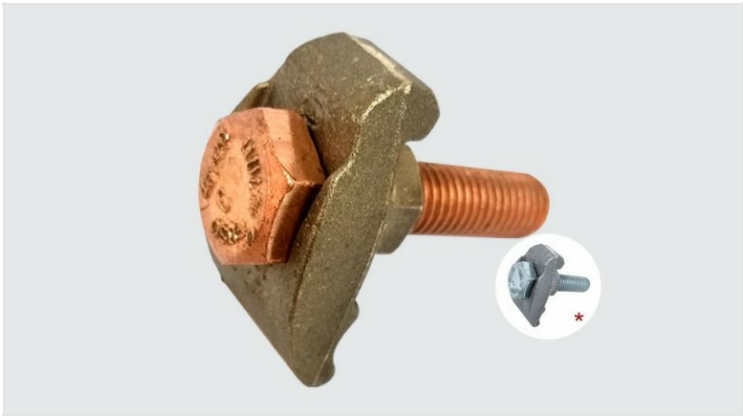

Datasheet

Conductor		
AWG/MCM		2/0 - 250
mm²		70 - 120
Dimensions (mm)		
L		37,0
A		52,0
C		50,0
Screw - E		M12
Figure		1
Package		
Qty. / Package		25
Unit Weight (g)		228,00