

GTSB2C - GROUNDING CLAMPS (2 CONDUCTORS)

GTSB2C-4-2/0

Description

Purpose: Cable to busbar connections. Suitable for copper or COPPERSTEEL cables.

Characteristics: Tightening connection. Electrical conductivity and corrosion resistant. Two conductors model. Screw length suitable for plate / bar thickness up to 7mm.

Application: Grounding systems in general (power distribution systems, grounding grids, residential, building, industrial grounding, grounding in telecommunications networks).

Material: Bronze clamp, fittings in copper alloy or hot galvanized steel.

Application Tool: Spanner set or open-ended wrench.

*Also available tin plated.

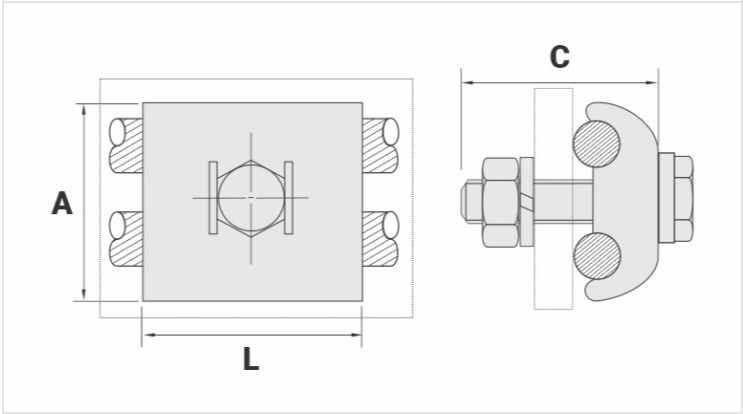
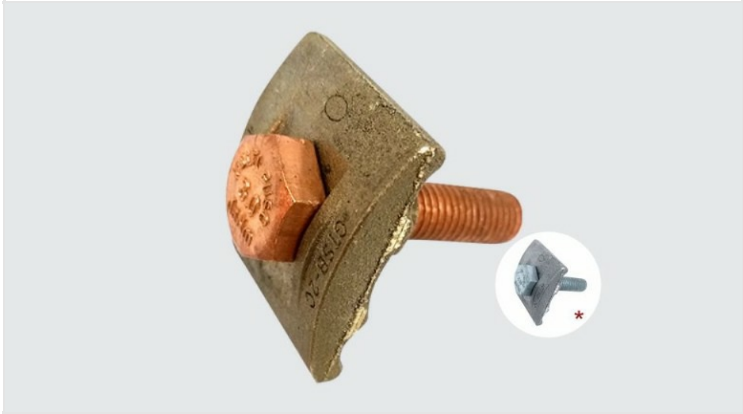

Datasheet

Conductor		
AWG/MCM		4 - 2/0
mm²		16 - 70
Dimensions (mm)		
L		35,0
A		40,0
C		45,0
Screw - E		M10
Figure		2
Package		
Qty. / Package		25
Unit Weight (g)		119,00