

GTSB2C - GROUNDING CLAMPS (2 CONDUCTORS)

GTSB2C-2/0-250

Description

**Purpose:** Cable to busbar connections. Suitable for copper or COPPERSTEEL cables.

**Characteristics:** Tightening connection. Electrical conductivity and corrosion resistant. Two conductors model. Screw length suitable for plate / bar thickness up to 7mm.

**Application:** Grounding systems in general (power distribution systems, grounding grids, residential, building, industrial grounding, grounding in telecommunications networks).

**Material:** Bronze clamp, fittings in copper alloy or hot galvanized steel.

**Application Tool:** Spanner set or open-ended wrench.

\*Also available tin plated.

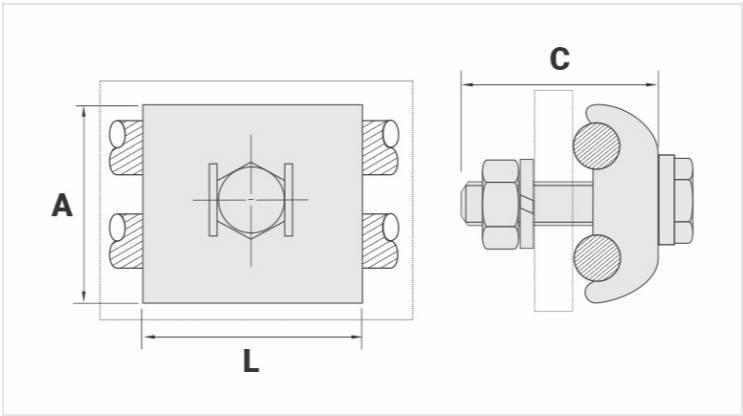
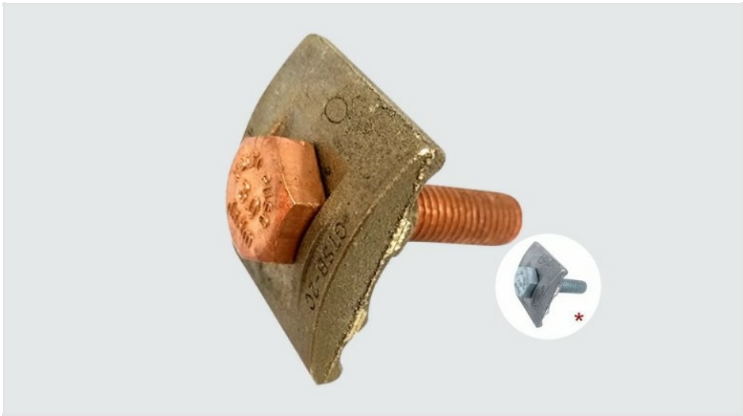

Datasheet

Conductor		
AWG/MCM		2/0 - 250
mm²		70 - 120
Dimensions (mm)		
L		41,0
A		54,0
C		50,0
Screw - E		M12
Figure		2
Package		
Qty. / Package		15
Unit Weight (g)		241,00